

8-Port Unmanaged Gigabit Switch

UTEPO

6kV Surge Immunity | 8kV ESD Protection | Three Operating Mode

Datasheet VER3.0

SG8-M



- 6*10/100/1000Mbps RJ-45 Ethernet ports + 2*10/100/1000Mbps uplink RJ-45 ports.
- IEEE802.3, IEEE802.3u, IEEE802.3ab, IEEE802.3x.
- Three operating modes (Default, VLAN, CCTV).
- Excellent performance of anti-interference, 6kV surge immunity & 8kV ESD protection.
- Plug and play.



Overview

The unmanaged gigabit switch is specially designed for HD video surveillance and network engineering, providing 8*10/100/1000Mbps RJ-45 ports. The switch supports three operating modes (Default, VLAN, CCTV). The switch supports 8kV ESD protection, which can protect the device from the damage by direct lightning and keep the stable transmission. The SG8-M is widely used in security video monitoring and network engineering etc.

Application

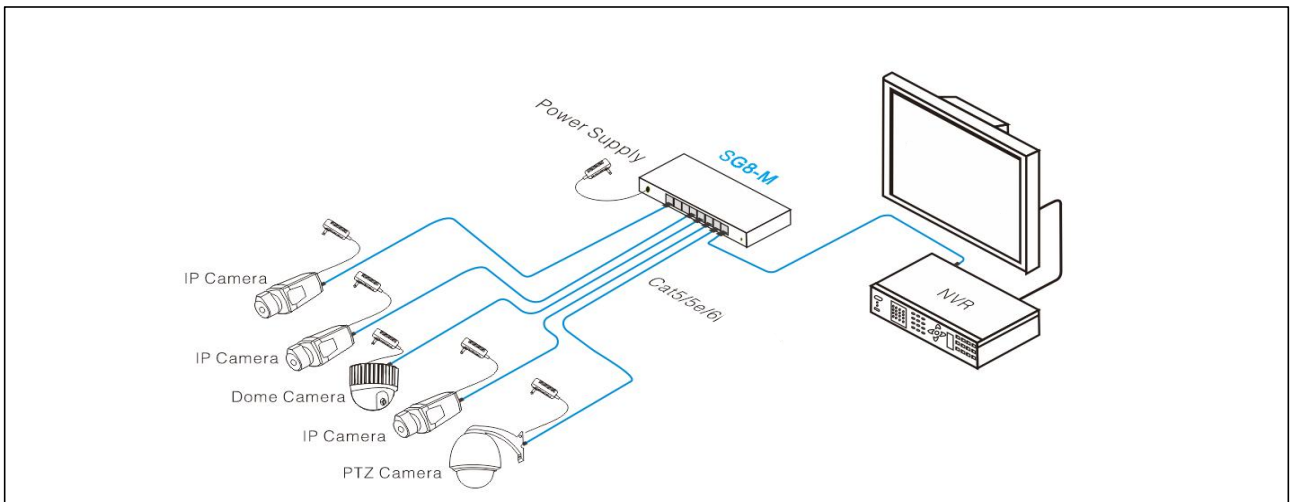

Physical Features

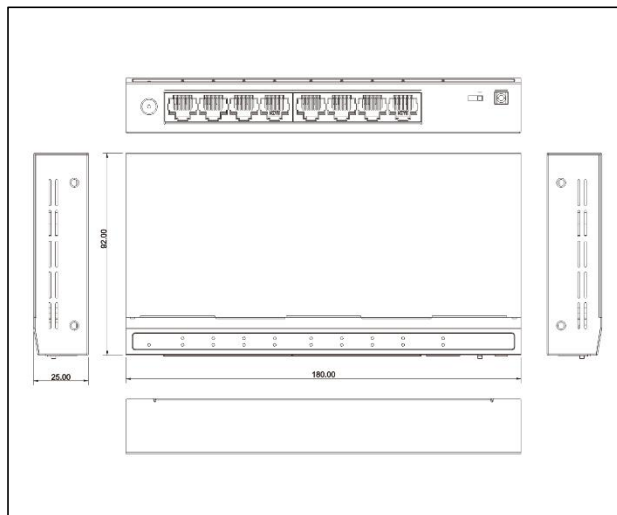

Interface drawing

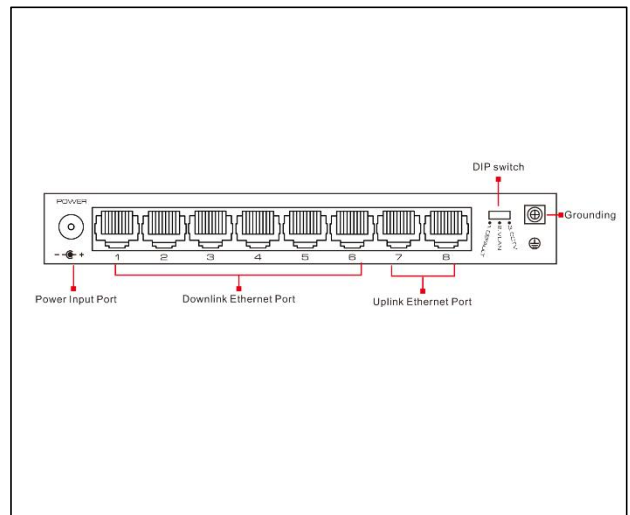

Specification

Model	SG8-M
Ethernet Ports	6*10/100/1000Mbps RJ-45 Ethernet ports + 2*10/100/1000Mbps uplink RJ-45 Ethernet ports.
Standard	IEEE802.3, IEEE802.3u, IEEE802.3ab, IEEE802.3x
Switch Capacity	16Gbps
Packet Forwarding Rate	12Mpps
Forwarding Modes	Store and Forward
Packet Buffer	2.5Mbits
MAC Table	4k
Jumbo Frame	9kB
Three working Modes	Default: All of the ports could communicate freely.
	VLAN: Ports 1~6 are isolated respectively, but can communicate with ports 7~8.
	CCTV: The transmission distance can be extended to 250 meters, while link speed of ports 1~7 will be limited to 10Mbps(Uplink port 8 keep 1000Mbps).
Surge Immunity	Common mode 6kV Execute: IEC61000-4-5
ESD Protection	Contact discharge 6kV , Air discharge 8kV Execute: IEC61000-4-2
Power Supply	Desktop power adapter, DC 2.1 Jack
Power Input	AC: 100~240V- 50~60Hz
Power Output	DC: 5V 1A
Power Consumption	<5W
Operating Temperature	-10°C~50°C
Storage Temperature	-40°C~85°C
Operating Humidity	5%~95% (Non-condensation)
Dimensions (W * D *H)	180mm*92mm*25mm
Gross Weight	437g±10g
Net Weight	303g±10g
Certification	CE, FCC, ROHS

Packing List

Item	Quantity
SG8-M	1
Power Adapter	1
User Manual	1

Related Product

Name	Model
5-Port 100M PoE Switch	SF5
5-Port Gigabit PoE Switch	SG5-M
8-Port 100M PoE Switch	SF8